

# Bourne Morton Drive



Popular, deceptively spacious design

Attractive landscaped garden, off road parking

Sought after 'Rings' location within Ingleby Barwick

Stylish and impressive throughout

Early viewing advised

**£174,995**



Multi-Award Wining



This especially attractive property enjoys a landscaped rear garden, with astro-turf lawn, and boasting a sunny, westerly rear aspect., with off road parking, whilst being situated within the very popular 'Rings' development of Ingleby Barwick, ideal for fantastic local amenities.

Still feeling brand new - internally, the property is especially stylish, tasteful and deceptively spacious, early inspection is strongly advised. Very briefly, the accommodation comprises an entrance hall, cloakroom/WC, lounge and separate kitchen/diner to the ground floor. The first floor brings three bedrooms, 'Master' with en-suite, and separate family bathroom. Being of particular interest to the 'first time' or 'buy to let' purchaser, Ingleby Homes recommended.

GROUND FLOOR  
384 sq.ft. (35.7 sq.m.) approx.

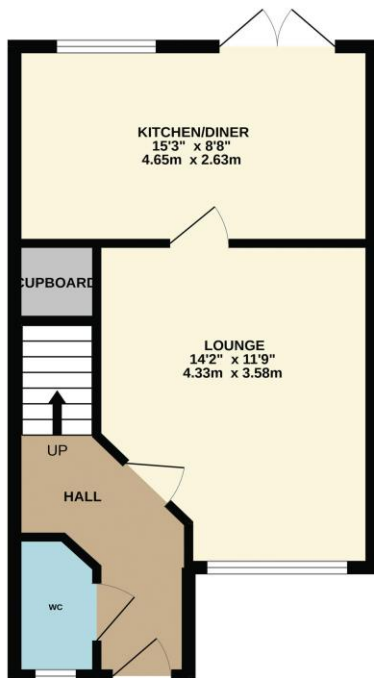

1ST FLOOR  
349 sq.ft. (32.4 sq.m.) approx.

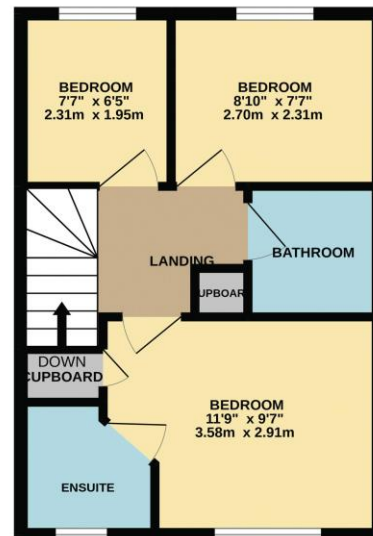

TOTAL FLOOR AREA - 732 sq.ft. (68.1 sq.m.) approx.

Whilst every attempt has been made to ensure the accuracy of the floorplan contained here, measurements of doors, windows, rooms and any other items are approximate and no responsibility is taken for any error, omission or mis-statement. This plan is for illustrative purposes only and should be used as such by any prospective purchaser. The services, systems and appliances shown have not been tested and no guarantee as to their operability or efficiency can be given.  
Made with Metropix ©2022



# “The Ingleby Barwick Experts”

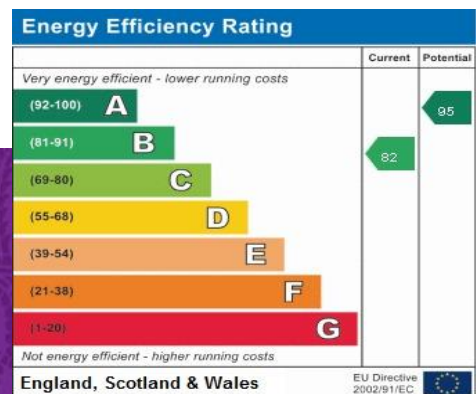

Tenure: Freehold

Council Tax Band: C



AGENTS NOTE: Every care has been taken with the preparation of these details, but they are for general guidance only. Measurements and dimensions are approximate, and any fixtures or fittings shown in photography does not infer that they are to be included within the sale. The agent has not tested any appliances or supplies and professional verification of these should be sought prior to purchase if required. These particulars do not constitute a contract or part of a contract.